

# Polygon mirror scanner PM unit



Ultrafast beam deflection

Up to 20 mm aperture

Custom design

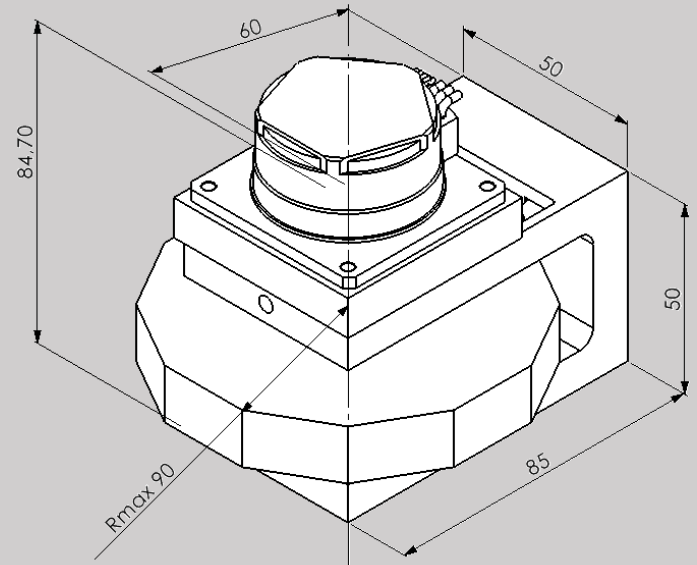
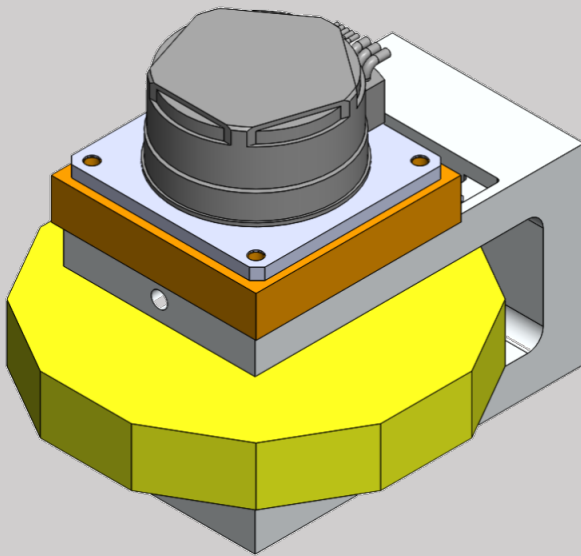

MOEWE's polygon mirror unit (PM unit) is a customer configurable polygon mirror with a motor and a driver. The PM unit is designed as a cost-efficient, high speed beam deflection unit for the integration in individual

## KEY FEATURES

- Individual number of facets
- Free aperture up to 20 mm
- Ultra-fast scan speeds on the entire scan length (no acceleration loss)

## Specs

### General specifications

Power supply	Voltage	12 - 48 V <sub>DC</sub> , GND
	Power	max. 100 W
	Ripple/Noise	max.200 mVpp
Operating temperature		+18...+30°C
Humidity		20...90 % rel.H.
Wight		<1 kg
Size (LxWxH)		<110 x <90 x 85

### Interface

Mechanical	4x M5	or custom
PLC		3 – in / 3 - out
Feedback	optional	Inc. Encoder
Expansion	optional	custom

operation environment. The PM unit stands out with free selectable aperture up to 20 mm and individual number of polygon facets. The nominal drive is able to run up to 5,000 rpm. Other speed or individual specs on request.

- Easy to integrate
- Double-sided bearing
- Custom design

### Optical specifications

Facets	Individual number
Max. Lines / s	RPM x FACETS x 0.2095
Max. scan speed	RPM x FOCAL LENGTH / 60
Wavelength	NIR >1,000 nm (Au)
	VIS 400 - 650 nm (enhanced Al, Ag)
	UV 350 - 365 nm (UV enhanced Al)
	other on request
Free Aperture	< 20 mm
Max. Diameter	90 mm